

Heavy Duty Metal Cavity Units

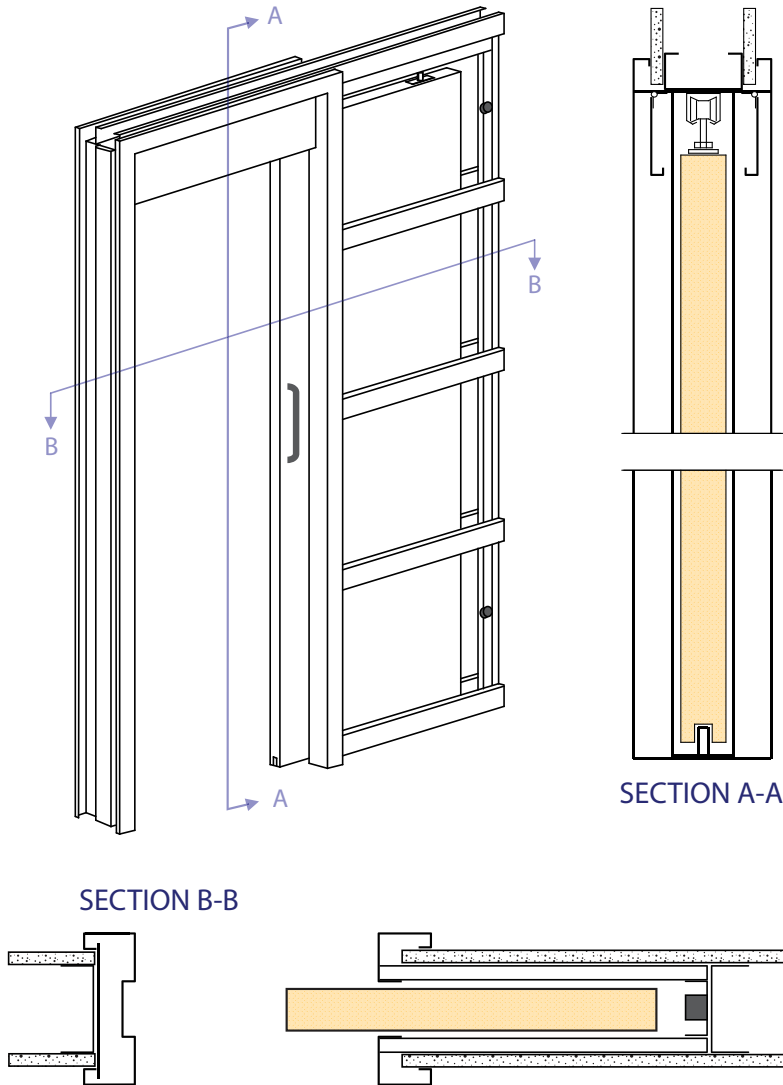

- Heavy duty cavity sliding door units
- Designed for domestic, commercial and industrial applications.
- Frame profiles are manufactured to suit wall thickness.
- Custom made to doors sizes.
- Units fabricated from 1.1mm zinanneal.
- welded and shop primed ready for installation.

Standard Track and Carrier.

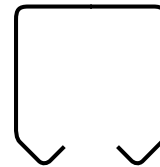

Joey Twin Track
Steel track
Galvanised

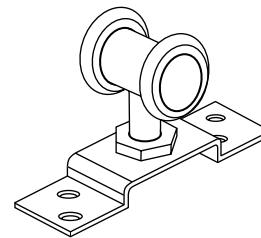

Joey Carrier
2 Nylon Wheels
Quiet operation
Carries 90 kg

DOOR FITTED PROUD OF JAMB

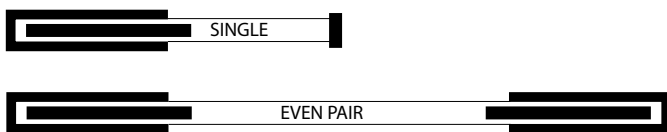

Door protrudes 45mm from split jambs when fully open.

DOOR FITTED FLUSH WITH JAMB

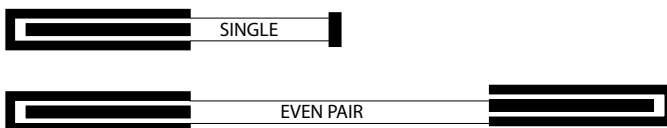

Doors finish flush with the jambs when fully open.

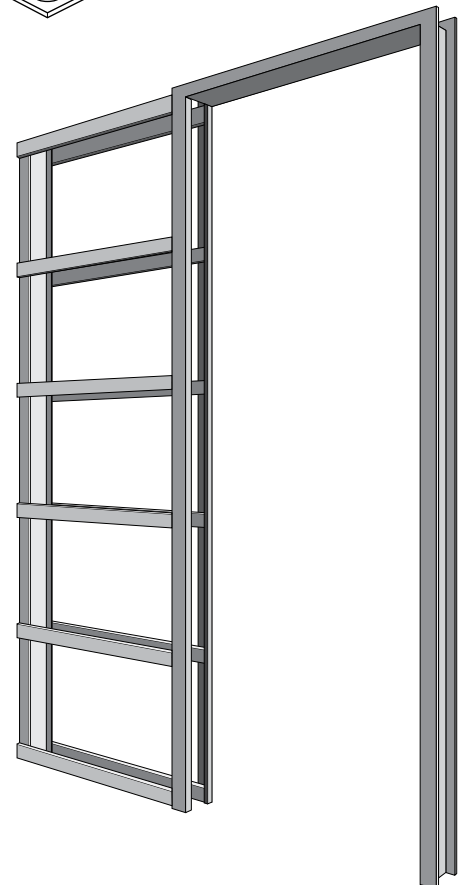

Heavy Duty Metal Cavity Units

Installation diagram

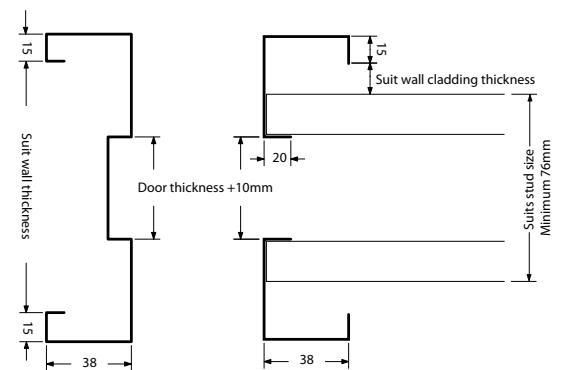
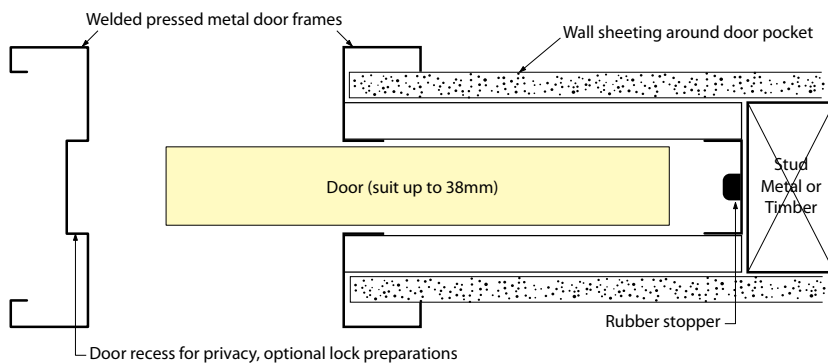

Standard Units are designed to suit:

- Clearance under the door of 20mm adjustable to 6mm.
- direct mounting to finished floor surface.

Cavit Unit will be supplied with:

- Pressed metal frame and pocket designed for cavity units.
- Galvanised steel track with guide strips attached
- Complete packet of fittings including rollers, bracket, guide fingers and fixing screws.

Excludes door, door furniture and architraves.

IMPORTANT

- Fix the wall cladding with glue. Do not penetrate rails with screws.
- Ensure the track is level and is resting on track platform.
- Do not fix track inside cavity frame.
- Do not remove 'temporary' spacing blocks until ready to insert door. it is easier to install and clad with spacing blocks in place.
- The cavity clearance are at a minimum. Only seasoned doors of good construction should be used to avoid scraping caused by door warping.

